

THERMOSHIELD™

Closed Cell
Polyethylene
Foam Insulation
Sheeting
Pipe Insulation
Thermoflute™

THERMOSHIELD™ is a flexible thermal and sound insulation material constructed by laminating a closed cell cross linked polyethylene foam with a tough reinforced aluminium foil facing.

THERMOSHIELD™ features the following attributes:

- Is user friendly
- Odourless
- Completely closed cell
- Acoustical dampening properties
- Lightweight
- Fungi resistant:
 - Aspergillus Niger, Penecillium Citrinum, Rhizopas Nigricans, Claddosporium Resinae and Chatomium Globuosom
- Chemical resistant:
 - Water, Sea water, Brine, Soap and detergents, Diluted Acids, Diluted detergents/alkalis, Alcohol, Ketones, Esters

Thermoflute™ is a thermal enclosure consisting of a 5mm THERMOSHIELD™ outer surface bonded to a 5mm polypropylene fluted sheet. As well as the attributes listed above, **Thermoflute™** is made as a flat-packed boxed enclosure to help minimise heat transfer and act as an insulating box for many thermal applications.

THERMOSHIELD™ Heat Absorption Example

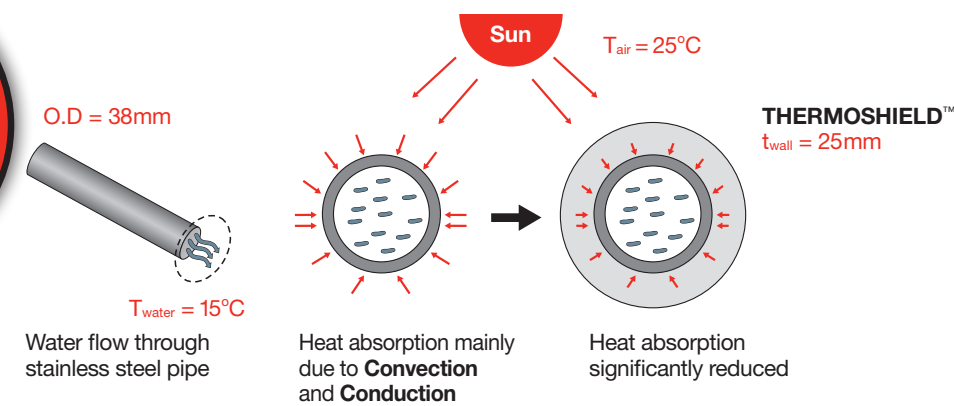

THERMOSHIELD™ Heat Absorption Loss

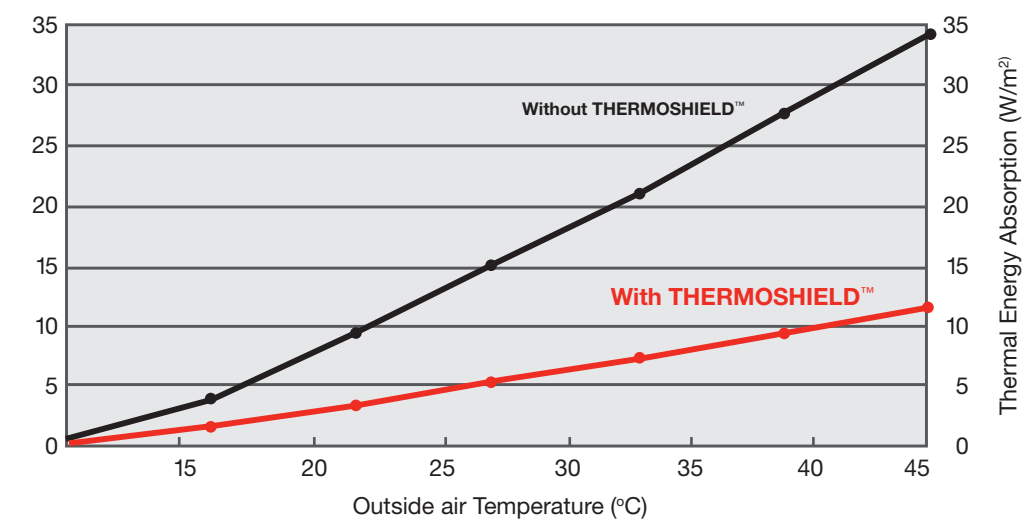

The information provided on this graph should only be used as a guide, with our company not giving warranty, express or implied, as to the accuracy, reliability and completeness of the graph. Our company does not accept liability for damage sustained from the use of these calculations.

Savings can be upwards of 65%

SIZE AVAILABILITY

Sheeting

THICKNESS mm	WIDTH mm	LENGTH m
5	1000	50
10	1000	25
15	1000	20
20	1000	10
25	1000	10

- THERMOSHIELD™ can be supplied with or without adhesive backing

Pipe Insulation

INNER DIAMETER mm	OUTER DIAMETER mm
19	69
25	75
32	82
38	88
50	100
63	113
76	126
89	139
101	151

- Wall thickness $t_{\text{wall}} = 25\text{mm}$
- Length: 1m or 2m
- Note: Other thicknesses and lengths can be provided upon request

Thermoflute™

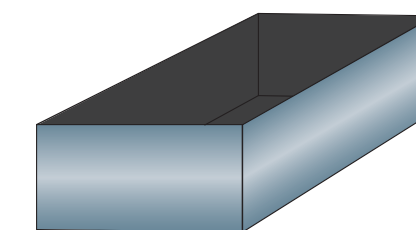
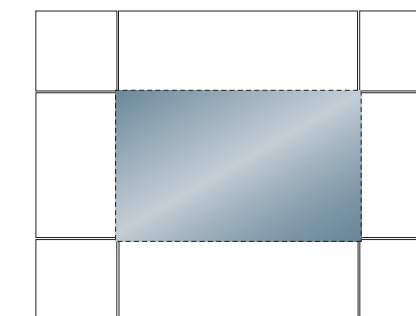

- Custom box sizes made upon request

PROPERTIES	ISO STANDARD	VALUE	UNIT
Thermal Conductivity	2581		
At 10°C		0.032	W/mK
At 20°C		0.034	W/mK
At 40°C		0.038	W/mK
Working Temperature Range	internal	-70/100	°C
Water Absorption (7 days)	internal	<0.5	vol %
Early Fire Hazard Properties	AS 1530.3 (foil faced)		
Ignitability		0	
Spread of Flame		0	
Heat Evolved Index		0	
Smoke Evolved Index		1	

* Full data sheet available upon request.